

ESTIMATE

Name of Scheme :- Rice Mill- Tejaswini loksanchalit sadhan Kendra - Tiroda

Dist- Gondia

Estimated Amount :- 1) Rice Mill Shed - Rs. 20,00,000 /-

2) Godown - Rs. 5,00,000 /-

1) Rice Mill Shed

REPORT

This estimate is amount Rs. 20,00,000.00 only to show the probable cost of the above mentioned scheme. The following provision and measurement is taken this estimate.

1. Plinth area 212.50 m²
2. Plinth wall Height 0.90 m
3. Brick work 0.112 m thick
4. Rolling Shutter
5. Post and Lintel RCC post with 12mm dia MS Rod and stirrup by 6mm dia Rod and lintel
10 mm dia MS Rod with 6mm Rod Stirrup.
6. RoofTruss M/S Black Tube
7. Roofing GCI Sheet with 55mm thickness.
8. Location Tiroda Dist- Gondia --- Bhu K. 237/2

Prepared By

Shubham

Er. Shubham Sakure

SHUBHAM UMESH SAKURE

Item no. 1 : Earthwork in excavation for foundation trenches for wall column, step, septic tank, etc including refilling the quantity as required after the completion of work.

a. In Ordinary Soil.

Post	= 1x44x0.60x0.60x0.90	=14.26 cu.m
F&B Wall	= 1x4x1 0x2. 40x0. 40x0. 40	= 15.36 cu.m
End Wall	= 1x4x3.40x0.40x0.40	= 2.18 cu.m
	= 1x2x0.90x0.40x0.40	= 0.29 cu.m
End & Partition	= 2x1 1x3.40x0.40x0.40	= 11.97 cu.m
	= 1x2x0.90x0.40x0.40	= 0.29 cu.m
Step	= 1x2x1.50x0.90x0.20	= <u>0.54 cu.m</u>
		= 42.42cu.m

@Rs.193.00/cu.m.....**Rs.8,187.00**

Item no. 2 : Providing Brick soling in foundation & under floor with best quality picked Jhama Brick. Sand packed & laid to level in panel after preparing the subgrade as directed.

Below post	= 1x44x0.60x0.60	= 15.84sq.m
Wall	= 10x4x2.75x0.40	= 44.00sq.m
End & Partition	= 2x11x3.75x0.40	= 33.00 sq.m
	= 1x2x1.25x0.40	= 1.00 sq.m
Step	= 1x2x1.50x0.90	= 2.70 sq.m
M.B.	= 1x1x25.00x8.50	= <u>212.50 sq.m</u>
		= 381.54sq.m

@Rs.386.371sq.m**Rs. 1,19,403.00**

Item no. 3 P.C.C work with coarse aggregate of sizes 13 mm in foundation bed for footings, steps, wall. Brick works as directed & specified.

Below Post	= 1x44x0.60x0.60x0.08	= 7.267cu.m
Wall	= 4x10x2.75x0.40x0.08	= 3.52cu.m
Ends & Partition	= 2x11x3.75x0.40x0.08	= 2.65cu.m
	= 1x2x1.25x0.40x0.08	= 0.08 cu.m
Step	= 1x2x1.50x0.90x0.08	= <u>0.216 cu.m</u>
		= 7.723 cu.m

@Rs. 5538/cu.m..... **Rs.42,769.00**

Item no. 4 : Supplying, fitting & fixing in position R/f Bars confirming to relevant I.S Code for R.C.C. work including straightening, clearing, cutting and bending to proper shape & length as per details and binding with 20 G annealed black wire and placing in position.

12 mm dia TMT for Post

M.B. post = 1x4x16x5.50 = 352.00 R.M

@0.89kg/R.M..... 3.13 qntl

10 mm dia TMT Bars

For post base plate = 1x16x10x0.60 = 96.00 R.M

Lintel and post plate = 8x4x8.70 = 278.4 R.M

Ends and partition wall = 2x4x11x9.70 = 853.60 R.M

T= 1228.40 R.M

@0.62ks/R.M..... 7.61 qntl

6mm dia M.S Rod for Stirrups@2Dcm C/C

For Post = 1x16x37x1.05 = 621.6 R.M

For Lintel = 1x8x151x0.55 = 664.40 R.M

Ends and partition = 2x11x49x0.55 = 592.90 R.M

= 1879.90 R.M

@0.22 kg/R.M..... 4.13 qntl

Add 5% wastage 0.74 qntl

15.61

@ Rs 8178.78 /Qtl..... **Rs. 1,27,670.00**

Item no. 5 : Brick work in cement mortar with 1\$ class brick including racking out joints & curing complete as directed in sub structure upto plinth level.

C In Prop 1:56

M.B. = 1x3x5x2.75x 1.14x0.25 = 11.75 cu.m

Ends & partition = 2x5x3.75x1.14x0.25 = 10.54cu.m

= 1x1x1.25x1x0.25 = 0.31cu.m

= 22.60 cu.m

@ Rs 4423.20 / cu.m **Rs.99,964.00**

Item no. 6 : Providing earth filling in plinth in layers not more than 150 mm thick including necessary cariage, watering, ramming etc. complete as directed and specified including payment of land Compensation, Forest Royalty, Sales Tax & other duties & Taxes as may be necessary.

C with Silt (Pre dominantly Non-Plastic Soil)

M.B. = 1x1x25.00x8.50x0.90 =191.25 cu.m

@Rs 422.75 cu.m**Rs.80,850.00**

Item no. 7: Proving and laying R.C.C works cement with coarse sand & 20 mm down graded stone aggregate including dewatering if necessary and curing complete as directed.

(A) (a) M 15

M.B. Post = $1 \times 16 \times 0.25 \times 0.25 \times 1.80$ = 1.80 cu.m

@ Rs 6666/cu.m **Rs 11,998.00**

(A) Super structure from P.L upto floor level

M.B. = $1 \times 16 \times 3.73 \times 0.25 \times 0.25$ = 3.73 cu.m

Lintel and PP = $2 \times 4 \times 25.00 \times 0.13 \times 0.13$ = 3.38 cu.m

Ends and Partition = $2 \times 5 \times 8.50 \times 0.13 \times 0.13$ = 1.40 cu.m

Deduct for post = $2 \times 16 \times 0.13 \times 0.13 \times 0.25$ = (-)0.13 cu.m

= 8.38 cu.m

@ Rs 6953.57/cu.m..... **Rs.58271.00**

Item no. 8: 112mm thick 1't class brick nogged wall in mofrar including racking out joints and curing complete as directed in super structure above plinth upto 1't floor level.

(b) 1;5 ratio

Upto Lintel

M.B. = $2 \times 10 \times 2.75 \times 2.40$ = 132.00sq.m

Ends and partition = $2 \times 11 \times 3.75 \times 2.40$ = 198.00sq.m

Above Lintel

MB = $2 \times 10 \times 1.20 \times 2.75$ = 66.00 sq.m

Ends and partition = $1 \times 2 \times 1.25 \times 1.20$ = 3.00sq.m

Gabble End = $1 \times 2 \times 0.50 \times 9.50 \times 1.50$ = 12.75 sq.m

= 510.75

@Rs 499.76/sq. m..... **Rs.2,55,252.00**

Item no. 9: 40 mm thick C.C floor consisting of 50 mm under layer of cement concrete 1:3:6 and 15 mm thick wearing layer in cement concrete L:I:2laid in panels and finished with a floating coat of neat cement finish complete as directed.

MB = $1 \times 1 \times 25.00 \times 8.50$ = 212.50 sq.m

@Rs 345.32/ sq.m **Rs.73,380.00**

Item no. 10: Providing formwork of ordinary timber plankings so as to give a rough finish including centering, shuttering, strutting and propping ets

3.1.1.1. :foundation, footings, bases of columns, pile cap, raft and mass concrete works etc.

Using 25mm thick planks.

For post above P.L	= 2x16x3.75x0.30	= 36.00 sq.m
	= 2x16x3.75x0.25	= 30.00sq.m
Lintel	= 2x4x10x2.75x0.15	= 33.00 sq.m
	= 4x1x10x2.75x0.13	= 14.30 sq.m
Ends & Partition	= 4x2x11x3.75x0.15	= 49.50 sq.m
	= 4x1 x1 1x3.75x0.13	= 21.45 sq.m
	= 4x2x1.25x0.15	= 1.50 sq.m
	= 4x1x1.25x0.13	= <u>0.65 sq.m</u>
		= 186.4 sq.m
	@Rs 213.73/ sq.m	Rs . 39,839.00

3.1.1.3 : Coumns, Pillars, Post and Struts:

ii. using 25mm thick planks.

For post upto P.L	= 2x16x1.8Ax0.30	= 17.28 sq.m
	= 2x16x1.80x0.25	= <u>14.40 sq.m</u>
		= 31.66 sq.m

@Rs 210/sq.m Rs. 6652.00

Item no. 11: Providing welding fitting fixing hoisting and fixing of roof trusses with purline, bottom runner etc fabricated uot of a combination of two or all of the following section i. square trottow section ii. Rectangular hollow section, iii. M/S black tubes as per approved designincluding M/S clit, base plate bolts and nuts etc complete as directed.

48.30 mm dia M/S Black Tube

Tie	= 1x1 1x9.70	= 106.70 R.M
K.post	= 1x1 1x1.50	= 16.50 R.M
Rafter	= 2x11x5.50	= 121.00 R.M
Strut	= 2x1 1x1.30	= 28.60 R.M
Q post	= 2x1 1x1.00	= 22.00 R.M
Strut	= 2x11x0.90	= 19.80 R.M
	= 2x11xA.70	= <u>15.40 4.M</u>
		= 330.00R.M

@3.60kg/R.M.....11.88 Qnt.

33.70 mm dia IOS Black Tube

MB Purline	= 2x5x31.00	= 310.00 R.M
@2.42kg/R.M	7.53 Ontl	
		19.41 Qntl

Add Base Plate, Gasket Plate, Nuts & Bolts J hook etc (L/S) 3.00 Qntl
22.41Qnt

@ Rs. 7,126.00/Qnt1..... Rs. 1,59,694.00

Item no. 12 : Providing GCi sheet roofing of TATA SHAKTEE/SAIL including fitting fixing necessary calved J or L hooks, bolts and nuts, 8 mm dia bitumen washer, 25 mmx 3 mm thick and 1.6 mm thick limpet washer complete as directed.

C. 0.55 mm thick

M.B. = 1x2x226.00x5 = 312.00 sq.m

@Rs 409.10/ sq.m **Rs. 1,27639.00**

Item no. 13 : Providing GI ridging including supplying & fixing necessary Calved Screws/washers etc. complete as directed.

E. 0.63 mm thick

(i) 230mm Lapping

M.B. = 1x1x26.00 = 26.00 R.M

@ Rs. 148.88 /R.M **Rs.3848.00**

Item no. 14 : Providing and fixing rolling shutters of approved make made of 80mm width MS Lathes interlocked together through their entire length and joint together at the ends and arrangement of inside and outside locking with push pull operation as directed.

M.B. = 1x10x4.20x3.00 = 126.00 sq.m

@Rs. 2563.10/ sq.m..... **Rs. 322950.00**

Item no. 15 : Providing wood work in frame of false ceiling partition etc sawn wrought framed hoisted and fixed in position with spikes, nails, M/S flat angle/clits with bolts and nuts complete-as directed.

B. With Hollock/Bonsum/Sundi.

M.B. = 1x9x25.00x0.08x0.05 = 0.9 cu.m
= 1x22x8.50x0.08x0.05 = 0.74 cu.m
= 1.64 cu.m

@Rs. 29812.40/ cu.m **Rs. 48891.00**

Item no. 16 : Providing fitting & Fixing AC building Board in ceiling with necessary nails, wood screws, including 1" class local wood (50mmx12mm)(Holloi/Bonsum/Sundij beeding incluiing pinting two coats to timber beeds complete as directed.

A4 mm thick

MB = 1x1x25.00x8.50 = 212.5sq.m

@Rs 315.99Rs. 67148.00

Item no. 17 : 15 mm thick cement plaster in single coat on rough side of single half brick wall including curing as directed.

(b) Using 1:4 ratio

Below plinth

MB Plinth

MB (F&B)	= 1x2x25.00x0.60	= 30.00sq.m
Ends	= 1x2x9850x0.60	= 10.20sq.m
Step	= 1x2x1.50x1.80	= 5.40sq.m
Step end	= 1x2x0.60x0.30	= 0.36sq.m
	= 1x2x0.30x0.30	= 0.18sq.m

Above pl

MB outside	= 1x2x25.00x3.75	= 187.50sq.m
MB end	= 1x2x8.00x3.75	= 60.00sq.m
Gable ends	= 1x2x0.5x8.50x1.50	= 12.75sq.m
MB inside	= 2x20x4.0x3.75	= 600.00sq.m
	= 1x20x3.00x3.75	= 225.00sq.m
MB Post	= 1x22x0.25x3.75	= <u>20.63sq.m</u>
		= 1152.02 sq.m

@Rs 191Rs. 220035.00

Item no. 18 Providing surface preparation for walls, ceiling etc using average 150mm thick plaster off including clearing, rubbing with sand paper, filling gaps, depression etc where necessary.

Quantity same as Item No- 17 = 1198.22 sq.m

@Rs 97.....Rs. 111745.00

Item no. 19 : Painting two coats (wcluding priming coats) on new steel and other metal surface with enamel paint of approved brand and manufacture (Asian ?arnglBerger Rangoli/J&N PaintA.,lerolac) on new surface to give an even shade after thruoghly brushing the surfaces free from mortar droppings and other foreign matters etc.

i. Surfaces over 100 in width and guard.

High Gloss.

Rolling Shutters = 1x10x4.20x3.00 =126.00sq.m

@Rs.109.64/sq.m..... Rs.13,815.00

Total = Rs. 20,00,000.00

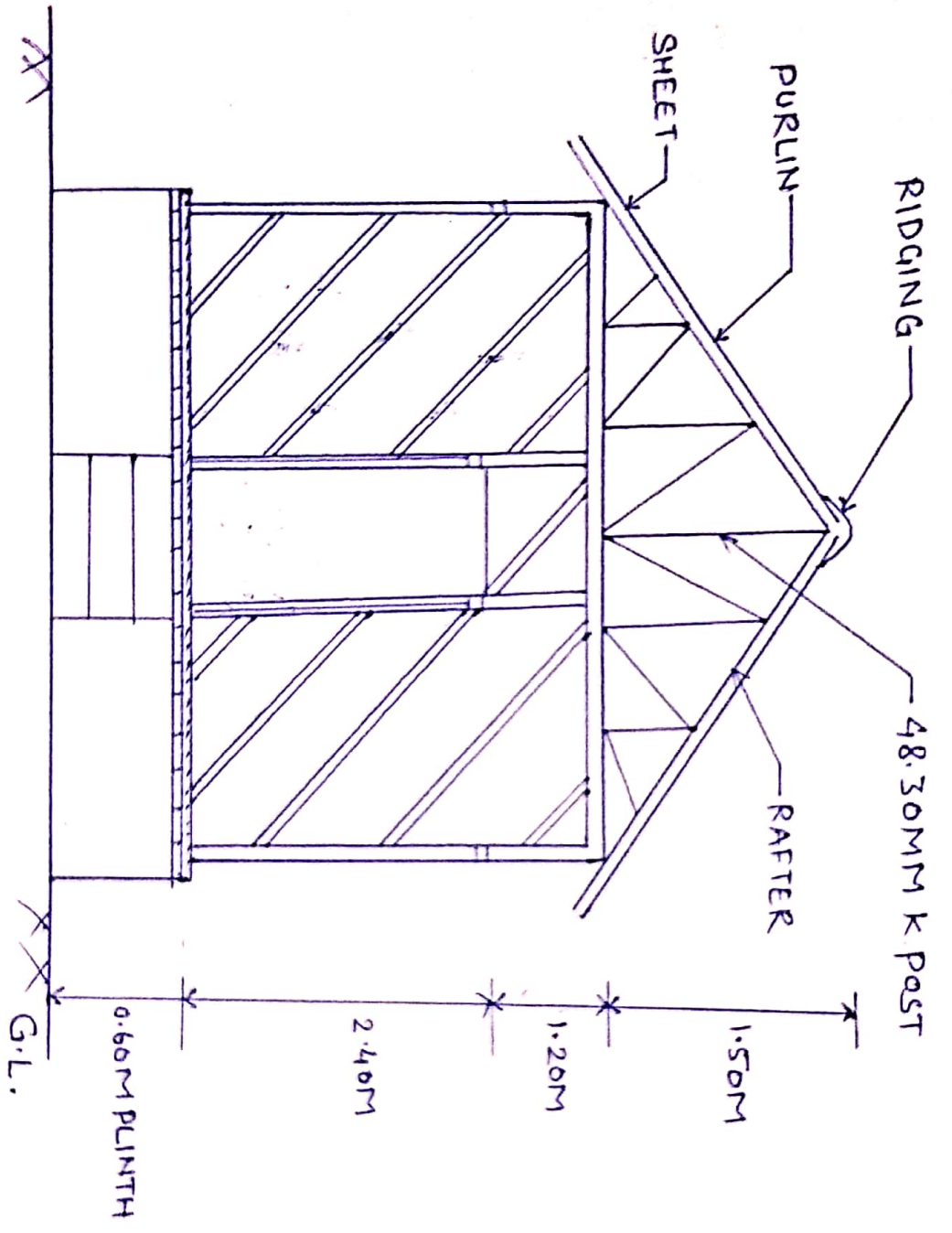

SECTION AT X-Y

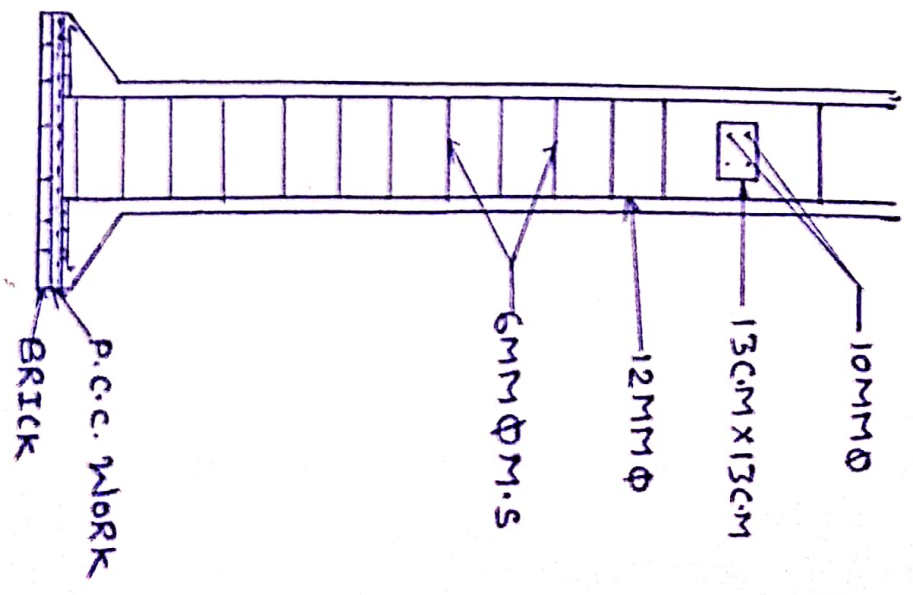

POST

SHUBHAM UNESH SAKURE

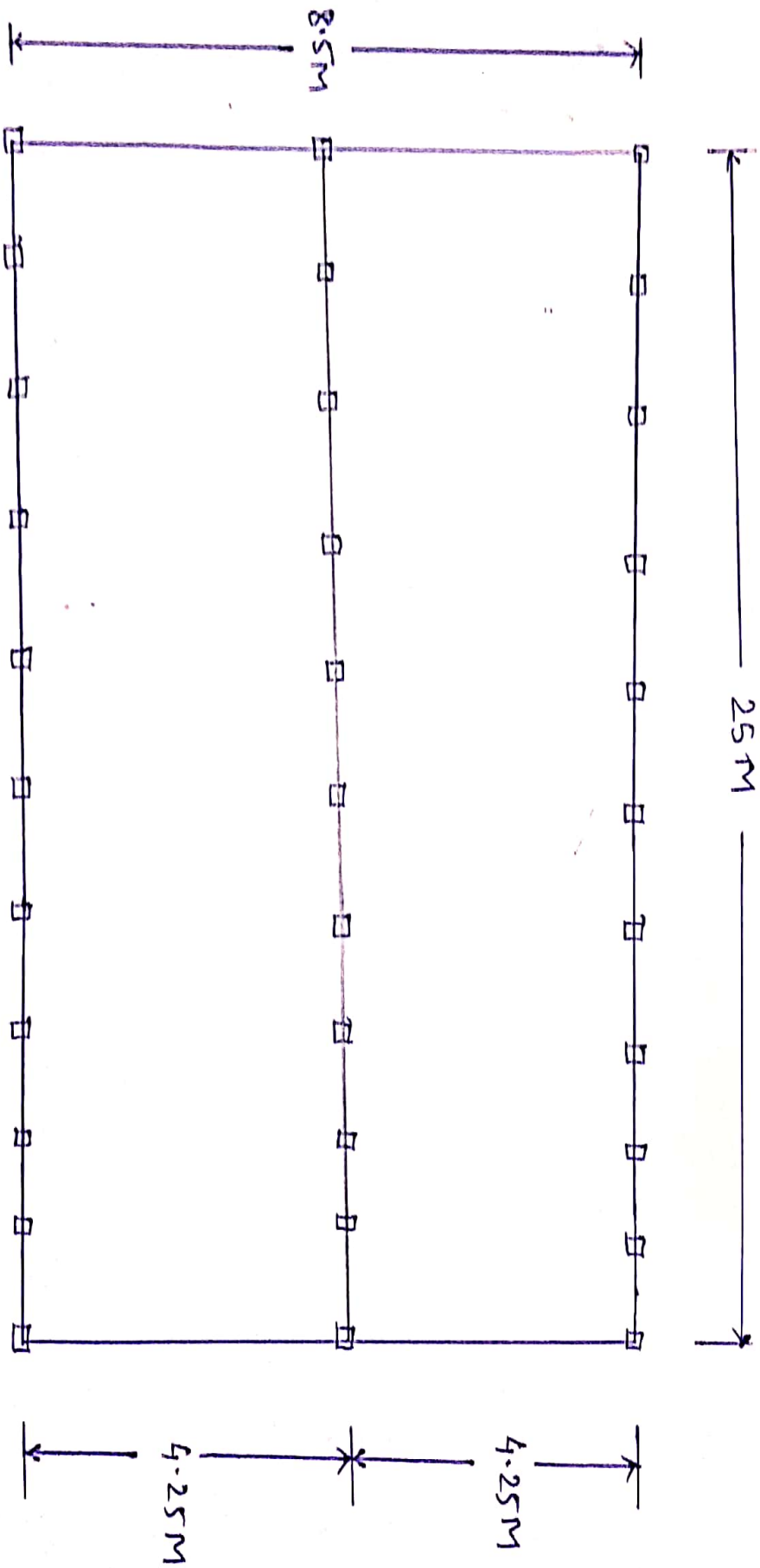

PLAN OF RICE MEEL SHED

Shubham
SHUBHAM UMESH SAKURE

2) Godown

REPORT

Design Scope :

Size 14 M x 6.9 M and the height of the building will be ten and half from floor to ceiling. The plinth will be of 2 ft elevated from the ground. The two sides of the building will be of gravel wall and roof will be GCI sheet on steeled tubular structure. The floor will be of Cement finish. The entrance of the hall, there will be a verandah of size 10 ft x 7 ft with R.C.C. roof with 2 rounds pillars and the floor will be of cement finish. Doors are D 1 and on D 2 and window W 1 to S 5 Box Chajja with grill protection. The measurement is given as below against the D 1 and D 2 = 4.5 ft x 7 ft. of wooden door on iron angled frame, W 1 to W 6 = 6 ft x 4 ft. of aluminium framed glass sliding window.

Estimated Cost : Rs. 5,00,000.00

Prepared By

Er. Shubham Sakure

SHUBHAM UMESH SAKURE

S.NO.	SSR	DESCRIPTION	Unit	Quantity	Rate	Amount
1	SSR-2021-22 Chapter-2 Item-2.3	<p>Earthwork in excavation in all kinds of soil in foundation, trenches of drains (not exceeding 1.5 m in width of 10 sqm. On plan) including dressing of sides and ramming of bottoms, lift up to 1.5 m, including getting out the excavated soil, stacking the suitable soil properly for using the same in the building below floor and disposal of surplus excavated soil as directed, within a lead of 50 m as directed as per clauses of Chapter – 2 of CPWD specification</p> <p>a. Without dewatering Coll footing = 1x16x1.00x1.00x0.90 =14.40 cum Wall footing= 1x1.36.8x0.50x0.60=13.25 cum Total = 27.65 cum</p>	cum	27.65	322.8	8925.42
2	SSR-2021-22 Chapter-2 Item-2.4	<p>Filling in trenches, plinth, under floor, sides of foundations etc. with available excavated suitable soil in regular horizontal layers, each not exceeding 200 mm in depth with all lead and lifts, consolidating each layer by watering and ramming with steel rammers of ½ tone roller as per clauses of Chapter – 2 of</p> <p>Under Floor = 1x14.75x7.5x0.50=55.31 cum Side of footing=2/3x27.65 =18.43cum Total 73.74 cum</p>	cum	73.74	148.50	10950.39

3	SSR-2021-22 Chapter-2 Item-2.8	<p>Filling in trenches, plinth, under floor, foundations etc. as per design with dands with all lifts, transporting to site, spreading in regular horizontal layers, watering, grading to required slope and compacting each layer by using plate compactor or by any suitable method as per clauses of Chapter - 2 of CPWD specification.</p> <p>1. With fine sand obtained from local quarry.</p> <p>Cool footing=1x16x1.00x1.00x0.075=1.20 cum</p> <p>Wall footing=1x1x52.8x0.60x0.075=2.38 cum</p> <p>Under Floor=1.15.00x7.75x0.15 = 17.44 cum</p> <p>1x3.00x2.15x0.15 = 0.97 cum</p> <p>Total = 21.99 cum</p>	cum	21.66	1592.20	34487.05
Sub Head-Cement Concrete Work						
4	SSR-2021-22 Chapter-3 Item-3.1	<p>Providing and laying in position cement concrete of specified grade including the cost of Form work, all work upto plinth level as per clauses of Chapter-4 of CPWD specification</p> <p>1. 1:4:8 (1 cement :4 fine sand:8graded well burnt brick aggregate of 40 mm nominal size)</p> <p>Cool footing=1x16x1.00x1.00x0.075=1.20 cum</p> <p>Wall footing=1x1x52.8x0.60x0.075 = 2.38 cum</p> <p>Under Floor=1x15.00x7.75x0.10 = 11.63 cum</p> <p>1x3.00x2.15x0.10 = 0.27 cum</p> <p>Total = 16.13 cum</p>	cum	16.13	4983.60	80385.47
Sub Head - R.C.C. Work						
5	SSR-2021-22 Chapter-4 Item-4.1	<p>Providing and laying in position reinforced cement concrete of specified grade including the cost of Form work. But excluding finishing and reinforcement, all work upto plinth level as per 1:1.5:3 (1 cement : 1.5 fine sand : 3 graded stone aggregate of 20 mm nominal size)</p> <p>Coil footing=1x16x1.00x1.30x0.15=2.40 cum</p> <p>1x16x15/4 (2+ 25+2)(1x25)=0.94 cum</p> <p>Total = 3.34 cum</p>	cum	3.34	8877.00	29649.18

6	SSR-2021-22 Chapter-4 Item-4.3	Providing and laying in positions reinforced cement concrete of specified grade in suspended floors, roofs having slope upto 15 degree, landings, balconies, shelves, chajjas etc. upto floor five level including the cost of frame work, but excluding finishing and	1. 1 : 1.5 : 3 (1 cement : 1.5 fine sand : 3 graded stone aggregate of 20 mm nominal Ent. Slab = 1.3.00x2.15x0.11=0.71 cum Chajja = 1x6x1.9x0.50x0.10=0.57 cum Total = 1.28 cum	cum	1.28	9278	11875.84
7	SSR-2021-22 Chapter-4 Item no. 4.4	Providing and laying in position reinforced cement concrete of specified grade in beams, lintels, bands, plain window sills, stair cases, spiral stair cases excluding pre-cast spiral stair case etc. upto floor five level including the cost of frame work, but excluding finishing and reinforcement, as per clauses of Chapter- 5 of	1. 1 : 1.5 : 3 (1 cement : 1.5 fine sand : 3 graded stone aggregate of 20 mm nominal Plinth beam= 1x52.80x0.25x0.25=3.30 cum Lintel beam=1x45.5x0.125x0.15 Entrance beam = 1x7.20x0.25x0.10=0.34 cum Total = 4.49 cum	cum	4.49	8581	38528.69
8	SSR-2021-22 Chapter-4 Item no. 4.2	Providing and laying in position reinforced cement concrete of specified grade including the cost of Form work, but excluding finishing and reinforcement, upto floor five level as per clauses of	a. In plinth & skirting courses, fillets, columns, pillars, post & struts etc. Column = 1x14x0.25x0.25x4 4=3.85 cum 1x2x3.14/4x25 ² /2x3.3=0.32 cum Total = 4.17 cum	cum	4.17	8162	34035.54
9	SSR-2021-22 Chapter-6 Item no. 6.2	First class brick work in foundation and plinth including cost of all materials required and as per clauses of chapter-6 of CPWD	1. In Cement mortar 1:6 (1 cement : 6 fine sand) Wall footing = 1x52.8x0.254x0.40=5.36 cum Total = 5.36 cum	cum	5.36	2835	15195.60

10	SSR-2021-22 Chapter-6 Item 6.13	Half brick masonry with first class bricks in superstructure above plinth level upto floor five level including cost of all materials required and as per clauses of chapter-6 of CPWD specification. 1 ln Cement mortar 1:4 (1 cement : 4 fine sand) Wall = 1x30.00x3.00=90.00 sqm Less = D=1x2x1.4x2.1 = 5.88 sqm W=1x6x1.80x1.20 = 12.96 sqm Total = 71.16 sqm	sqm	71.16	436.2	31039.99
11	SSR-2021-22 Chapter-10 Item no. 10.3	Providing and fixing glazing in aluminium aluminium doors, windows, ventilator, shutters and partition frames with P VC/neoprene gasket etc. complete as per architectural drawings and the direction of Engineer-In-charge and as per clauses of chapter 24 of CPWD specification A. With sglass panes of 4.0 m thickness (weight not less than 10.0 kg/sqm) W=1x6x1.80x1.20=12.96 sqm Total = 12.96 sqm	sqm	12.96	520.6	6746.98
12	SSR-2021-22 Chapter-9 Item no. 8.19	Providing and fixing M.S. grills of required pattern in frames of windows etc. with M.S. flat, solid square of solid round bars etc. all complete as per clauses of Chapter-9 of CPWD specification 1. Fixed to openings in walls with rawf plugs, screws etc. W=1x6x1.80x1.20=12.96 sqm @ 10 kg/sqm=129.60 kg Total = 129.6 kg	kg	129.60	169.3	21941.28

13	SSR-2021-22 Chapter-9 Item no. 9.11	Providing and fixing T-iron frames for doors, windows and ventilators of mild steel tea sections, joints mitred and welded with (15x3mm) lugs 10 cm long embedded in cement concrete blocks (15x10x10 cm) of 1:3:6 (1 cement, 3 fine sand 3 graded brick aggregate 20 mm nominal size) or with wooden plugs and screws or with fixing clips or with bolts and nuts as required including fixing of necessary butt hinges and screws and applying a priming coat of approved steel primer as per clauses of chapter 10 of CPWD specification D = 1x2x2x2 1=8.4 m 1x2x1x1.4 = 2.8 m 11.20m @ 3.5 Kg/m =39.20 kg Total = 39.2 kg	kg	39.20	102.34	4011.72
14	TSR-2021 Chapter-8 Item no. 8.5	Providing and fixing paneled/or paneled and glazed shutters for doors, windows and clerestory windows including bright finished black enamel M.S. butt hinges with necessary screws (excluding paneling and or glazing which will be paid for separately). But including the wooden beading of 20 x 12 mm for B Double leaf door shutter 1. Gamair wood a. 35 mm thick shutters D=1x2x1.40x2.10=5.88 sqm	sqm	5.88	936.7	5507.79
15	TSR-2008 Chapter-8 Item no., 8.41	Providing and fixing ISI marked aluminium sliding door bolts anodized (anodized coating not less than grade AC 10 as per IS 1868) transparent or dyed to required colour or shade with necessary screws etc. complete as per clauses of Chapter - 9 of CPWD specification 1. 300 x 16 mm Total = 2 nos	Nos	2.00	218.3	436.60
16	TSR-2008 Chapter-8 Item no. 8.42	Providing and fixing ISI marked aluminium tower bolts anodized (anodized coating not less than grade AC 10 as per IS 1868) transparent or dyed to required colour or shade with necessary screws etc. complete as per clauses of Chapter - 9 of CPWD specification 1. 300x10 mm Total = 2 nos	Nos	2.00	184.20	368.40

17	TSR-2008 Chapter-8 Item no. 8.45	Providing and fixing ISI marked aluminium handles with plate anodized (anodized coating not less than grade AC 10 as per IS 1868) transparent or dyed to required colour or shade with necessary screws etc. complete as per clauses of Chapter - 9 of CPWD specification. 1. 150 mm Total = 4 Nos	Nos	4.00	85.60	342.40
18	TSR-2008 Chapter-11 Item no.11.9	Sub Head-Flooring Work Providing and laying cement concrete 1:2:4 (1 cement 2 fine sand 4 graded well burnt brick aggregate) flooring finished with a floating coat of neat cement including cement slurry, rounding of edges and strips etc. complete as per clauses of Chapter - 11 of CPWD specification. 1. 25 mm thick with 12.5 mm stone aggregate Floor = 1x14.00x6.90=96.6 sqm Total 96.6 sqm	sqm	96.60	172.30	16844.18
19	TSR-2008 Chapter-13 Item no. 13.1	Sub Head-Finishing Work 12 mm cement plaster in single layer including cost of materials required and finishing even and smooth and curing complete as per clauses of chapter 13 of CPWD specification. 1. Cement mortar 1:6 (1 cement 6 fine sand) 1x4x10.00x3.00=120.00 1x4x6.00x3.00 = 72.00 Less D=1x4x(1/2)x1.4x2.1 =5.88 W=1x12x(1/2)x1.8x1.2=5.88 Total 173.16 sqm	sqm	173.16	148.20	25662.31
20	TSR-2008 Chapter-13 Item no 13.4	Wall painting with plastic emulsion paint (two or more coats) of required colour of approved brand and manufacture on new work to give an even shade including cost of materials required and as per clauses of Chapter 13 of CPWD specification. Inside wall = 1x2x15.00x3.20=96.00 1x2x7.75x3.20=49.60 Less-E=1x2x(1/2)x1.4x2.1=2.94 W=1x6x(1/2)x1.8x1.2=6.48 Total = 136.18 sqm	sqm	136.18		5737.26
42.13						

21	TSR-2008 Chapter-13 Item no. 13.2	Finishing walls with acrylic smooth exterior paint of required shade of approved brand and manufacture on new work (two or more coats applied @ 1.667 kg/10 sqm) over and including base coat water proofing cement paint applied @ 2.20 kg/10 sqm complete including cost of materials required and as per clauses of chapter	Outside wall = 1x2x15.00x3.20=96.00 1x2x7.75x3.20 = 49.60 Less-D=1x2x(1/2)x1.4x2.1 = 2.94 W=1x6x(1/2)x1.8x1.2=6.48 Total = 136.18 sqm	sqm	136.18	70.1	9546.22
22	TSR-2008 Chapter-9 Item no. 9.12	Providing and fixing steel work in built up tubular trusses including cutting, hoisting, fixing in position and applying a priming coat of approved steel primer, welded and bolted including special shaped washers etc. complete as per clauses of chapter-10 of CPWD specification.	1. With mild steel tubes Hot finished welded (HFW)/type medium class. Total = 350 kg	kg	350	122.3	42805.00
23	TSR-1008 Chapter-12 Item no. 12.1	Providing and fixing corrugated G.S. Sheet roofing fixed with polymer coated J or L hooks 8 mm diameter, bolts and nuts 6 mm diameter with bitumen and G.I. limpet washers or with G.I. limpet washers filled with lead and including a coat of approved steel primer and two coats of approved epoxy paint on overlapping of sheets complete (upto a pitch of 60 degrees) over a built structure including all types of necessary scaffoldings etc. but excluding the cost of the purlins, rafters and trusses etc. as per clauses of Chapter-12 of CPWD specification	1. 0.63 mm thick with zinc coating not less than 275 gm/m ² roof=1x2x14.00x3.45= 96.6 sqm Total = 96.6 sqm	sqm	96.6	599	57863.40

24	TSR-2008 Chapter- 12 Item no. 12.4	<p>Providing and fixing ridges or hips of 60 cm overall width of plain G.S. Sheet (class-1) fixed with polymer coated J or L hooks 8 mm diameter, bolts and nuts 6 mm diameter with bitumen and G.I. limpet washers and including a coat of approved steel primer and two coats of approved epoxy paint on overlapping of sheets complete as per clauses of Chapter – 12 of CPWD specification.</p> <p>1. 0.63 mm thick with zinc coating not less than 275 gm/m² roof = 1x1x14.00 = 14.00 sqm Total = 14.00 mtr.</p>	Mtr	14	522.38	7313.32
				TOTAL		500000.000

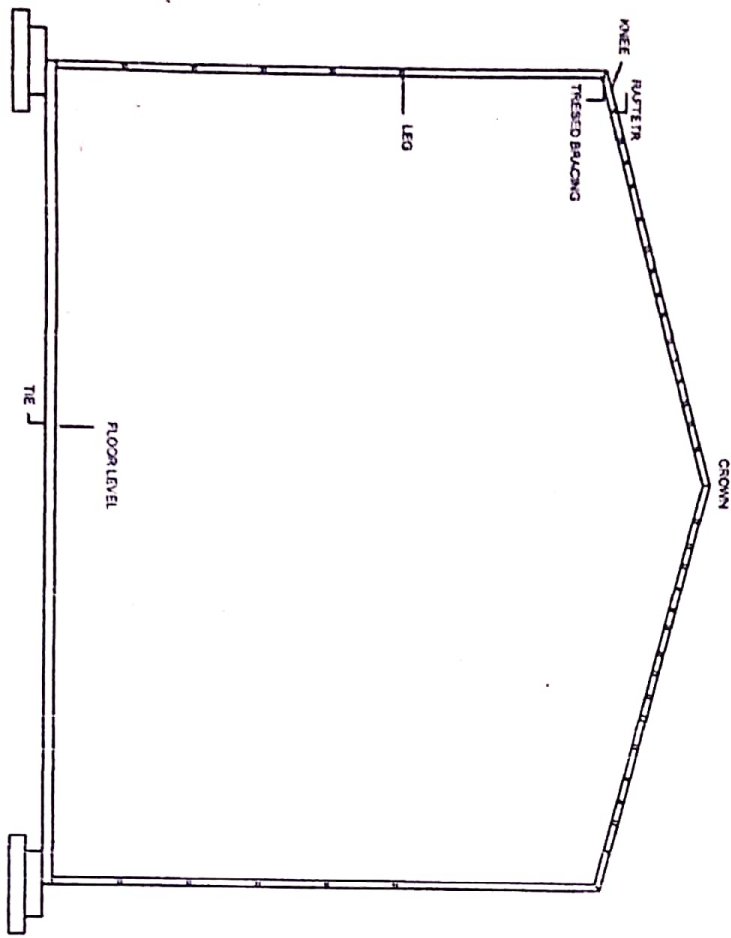

RICE MEAL GODOWN

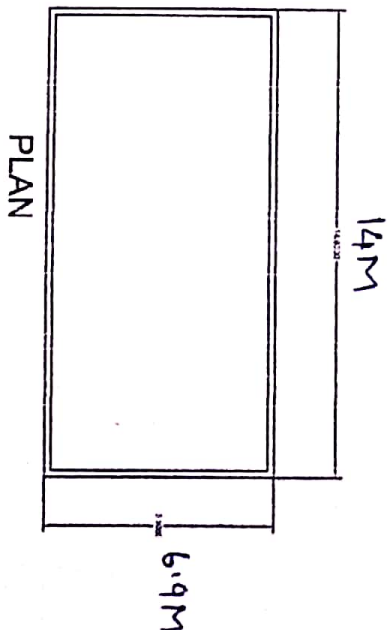

Shubham
SHUBHAM UMESH SAKURE